



6 Sutherland Road,  
Golspie, Sutherland KW10 6TX

Offers Over £115,000



3



1



1



E

A semi detached 2/3 bedroom cottage located in the coastal village of Golspie close to the beach. The cottage sits in a large garden front side and rear and has a vegetable garden and polytunnel. There are 3 garden sheds in the rear garden. The property is in need of modernisation.



HALL 5'6" x 7'6"

Entry to the property and access to the sitting room, bedroom 3 and stairs to the first floor.

SITTING ROOM 13'1" x 10'8"

Sitting room has alcoves either side of the chimney breast and overlooks the front garden

KITCHEN 11'5" x 11'9"

From the sitting room through to the kitchen which has worktop with open shelving below, space for a washing machine, cooker and fridge freezer.

BEDROOM 3 7'6" x 6'6"

A room that could be a third bedroom

BATHROOM 5'4" x 6'0"

Bathroom with white 3 piece bathroom set;- bath wash basin and w/c.

FIRST FLOOR

Stairs to the landing and bedroom 1 and 2. A velux window.

BEDROOM 1 7'10" x 10'9"

A double bedroom with open storage and window overlooking the front garden and the sea.

BEDROOM 2 7'6" x 5'10"

A single bedroom with velux window looking to Ben Bhraggie Hill.

GARDEN

The garden is laid to lawn and has mature shrubs and trees  
The side garden is fenced and contains some fruit bushes and a polytunnel.

A gate to the the front garden allows for off street parking

ADDITIONAL INFORMATION

- Council Tax Band - B
- External Wall Insulation
- Timber Framed Double Glazed Windows
- Electric Storage and Panel Heaters

LOCATION

Locate in the coastal village of Golspie on the NC500 Route.  
Close to all local amenities and transport links. Primary and secondary schools.

Virtual Tour Link

<https://youtu.be/FJz7oW7eLb4>

Area Map



Floor Plans

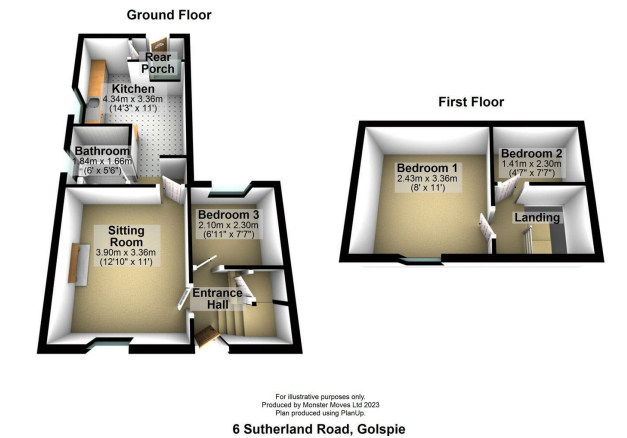

Energy Efficiency Graph

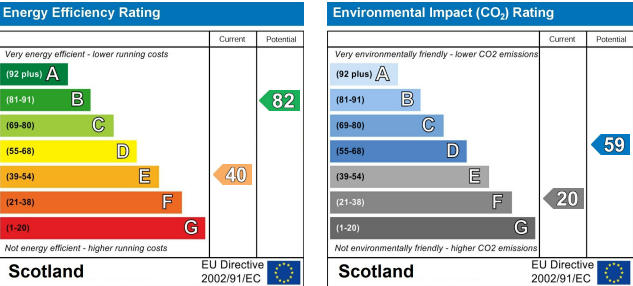



These particulars, whilst believed to be accurate are set out as a general outline only for guidance and do not constitute any part of an offer or contract. Intending purchasers should not rely on them as statements of representation of fact, but must satisfy themselves by inspection or otherwise as to their accuracy. No person in this firms employment has the authority to make or give any representation or warranty in respect of the property.